

LS275A-2: Star II

Warranty void if not installed as per installation instructions

DANGER

ISOLATE LUMINAIRE FROM POWER

Failure to isolate power supply before installation or maintenance may result in fire, serious injury, electric shock, death and may damage the luminaire.



WARNING

The luminaire should only be used complete with its protective shield (cover)

If cable is damaged replace with cable supplied by Lumascope only.

Do not shorten, interfere or disconnect cable from fitting. Warranty will be void if cable assembly is tampered with.

Luminaire must be installed and operated underwater at all times.

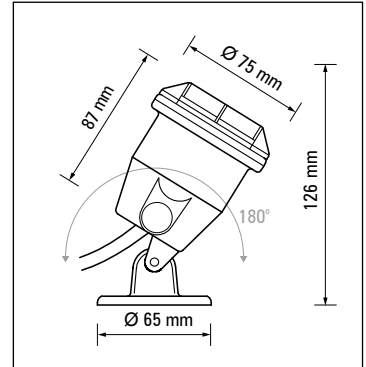

IMPORTANT: Submersed before lighting

1. Fit lamp as in re-lamping instructions (below and Fig. B).
2. Mount base plate using a suitable non-corrosive fastener. Two 6 mm stainless steel dynabolts are recommended for concrete mounting.
3. Fit fixture to base plate locating the stud in the base plate slot and tighten wingnut.
4. Run the cable out and connect to an isolating type transformer.
5. Do not loose joint the cable under water. All joints must be water tight.
6. Ensure that the supply voltage is 12 volts before switching on.
7. Aim fixture and tighten wing nut.

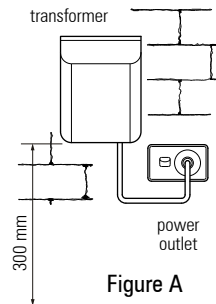

RELAMPING

1. Loosen wingnut and remove from base plate.
2. Lift the fitting from the water.
3. Remove the 4 stainless steel phillips head screws that retain the cover and lift off.
4. Remove the stainless steel circlip in the cover that retains the lamp.
5. Pull the holder off the lamp pins.
6. Inspect the lamp pins for burning. If there appears to be burnt pins replace the lamp holder using the LS275A-2 lamp holder replacement kit.
7. Fit the lamp holder onto the new lamp ensuring that it sits all the way on the lamp pins.
8. Fit lamp holder onto the front cover and refit the stainless steel circlip into its correct groove.
9. Inspect the seal and ensure that it is in good condition and correctly fitted.
10. Fit the cover to the body and fit all 4 stainless steel phillips head screws and tighten.
11. Submerge in the water before lighting.

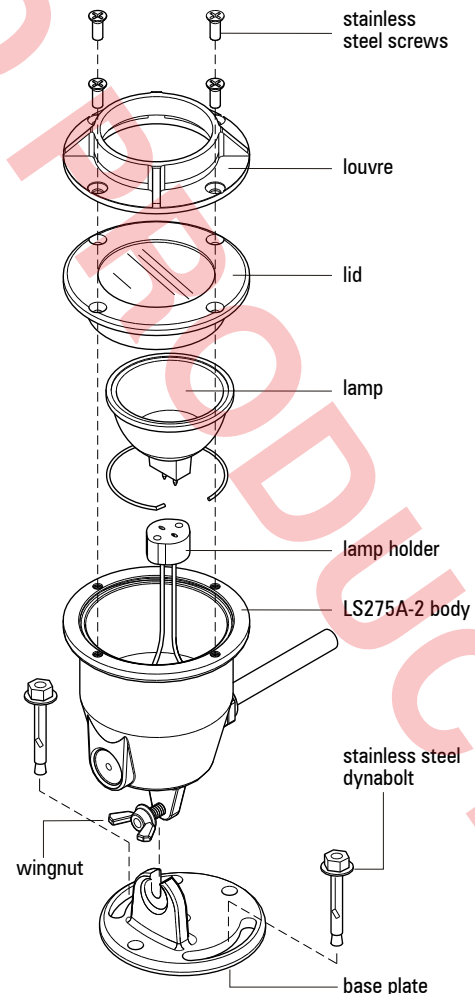

Figure B

CAUTION: FITTINGS CAN BECOME HOT. USE DISCRETION IN PLACEMENT

PLEASE ENSURE THAT INSTALLATION COMPLIES WITH LOCAL AUTHORITY STANDARDS

DISCONTINUED PRODUCT

Questions?
Call +61 7 3286 2299
Email sales@lumascape.com.au
www.lumascape.com.au

SAFETY INSTRUCTIONS

WARNING - To reduce the risk of FIRE or INJURY:

- 1. Luminaires and transformers to be installed by licensed electrical contractors.
- 2. Luminaires to be used for intended purpose only.
- 3. Do not operate the luminaires with a missing or damaged parts.
- 4. Use only genuine Lumascope parts to replace damaged or missing components.
- 5. Refer to instructions for installation and operating requirements.
- 6. Ensure installation complies with local regulations

Voltage insulation test (megger) will permanently damage product and will void warranty.

SAVE THESE INSTRUCTIONS.