



The LS843 is a 20 W metal halide luminaire used for general uplighting applications. Available with wall wash lens, this luminaire is ideal for low level wall washing. Measuring only 180 mm deep in direct burial format, the LS843 is suitable for reduced depth applications where other integral gear luminaires cannot be used.

**SPECIFICATIONS**

Lamp Source	MH / HIT T4.5 (G8.5) 20 W
IP Rating	IP68
Construction	316 marine grade stainless steel
Installation Types	Direct burial <i>Landscapes, etc.</i>  Mounting collar <i>Decks and grates</i>  Pre-installation blackout <i>Drive-over or other applications requiring pre-Installation (LS6052-K)</i>
Drive-over	With OptiClear™ lens and pre-installation blackout (LS6052-K)
Static Load Rating	4200 kg with OptiClear™ lens and pre-installation blackout (LS6052-K)
Impact Rating	IK10 with OptiClear™ lens
Standard Inclusions	Teflon coated cover screws MicroAntiLeach™ cable entry Thermal cutout Electronic control gear Humidity absorbent desiccant
Ambient Operating Temperature	-20 °C to 40 °C
Warranty	10 year structural, 1 year electrical
Accessories	Refer to page 63 for direct burial <i>Order separately</i> Refer to page 65 for pre-installation
Photometrics	Refer to page 66
Glass Temperature	HumanTouch™ compliant ≤65 °C

NOTE: Product specifications are subject to change without notice. Any luminaire can become hot - take care with appropriate use and placement.



**LS843 Recessed Cover**  
Metal halide with aluminium reflector



**LS843 Round Flush Cover**  
Metal Halide with aluminium reflector



**LS843 Pre-installation Round Flush Cover**  
Metal halide with aluminium reflector

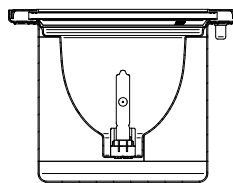

**XJ / XK**  
Fixed Aluminium Reflector

 **CONFIGURE THIS PRODUCT >**

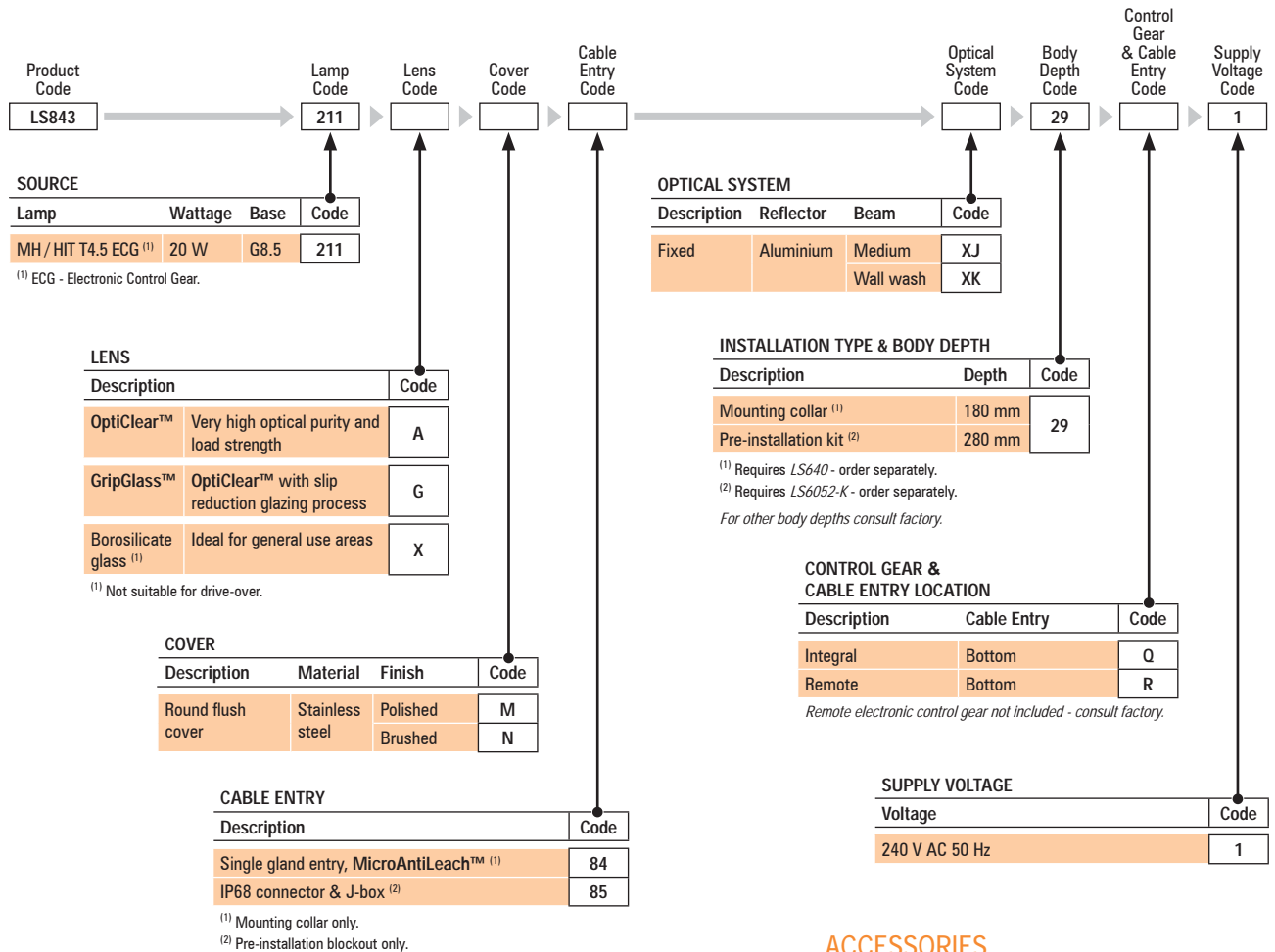

## ACCESSORIES

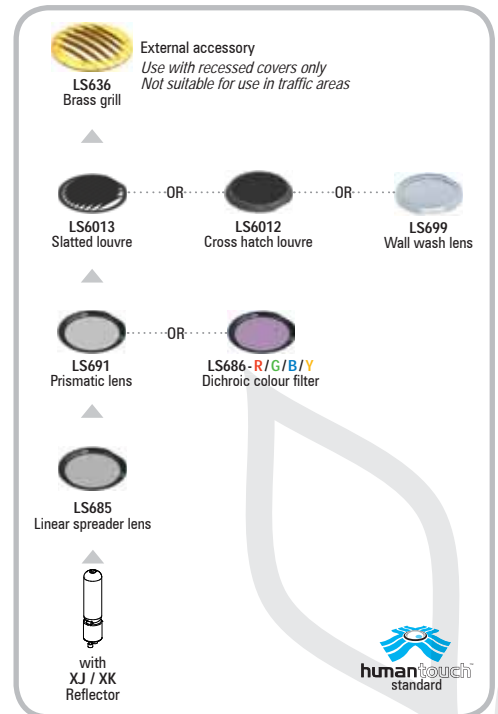

Other accessory stacking options may be available - consult factory

# LS843 Pre-Install & Mounting Collar Options

## WHY USE PRE-INSTALLATION BLOCKOUT

This type of installation requires the LS6052-K pre-installation kit (order separately) which acts as a blockout, and is intended for installation before the luminaire. This method ensures the luminaire itself is not damaged during concreting or other site works, and also allows for all wiring to be completed prior to luminaire placement. Pre-installation also

allows for off-site maintenance, via the detachable IP68 connector fitted on the luminaire housing.

The mating connector on the cable has a sealing cap which ensures water does not enter the cable before the installation is completed. Pre-installation is required for all drive-over applications.

## WHY USE MOUNTING COLLARS

The LS640 mounting collar supports installation in decks and grates. They may also be used in hollow floors where there is appropriate ventilation.

### Cable Entry Option for Pre-Installation Blockout

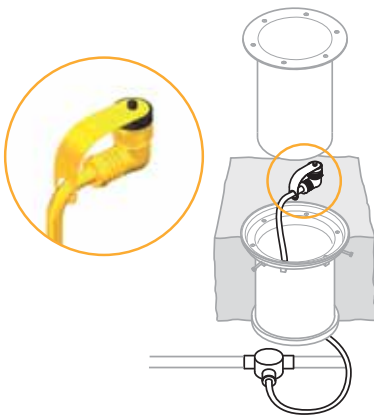

#### IP68 Connector & Junction Box

The luminaire is fitted with an IP68 connector, which attaches directly to the cable supplied with LS6052-K, without the use of any tools. The cable is 0.56 m in length, and is factory assembled with a 3 way junction box. LS640 mounting collars must use a single gland entry. *See page 62.*

### Lens Options

#### OptiClear™ Glass



Glass of very high optical purity and load strength. Suitable for drive-over applications.

#### GripGlass™

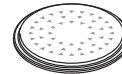

OptiClear™ glass with slip reduction glazing process. Suitable for drive-over applications.

#### Borosilicate Glass



Ideal for general use areas. Not suitable for drive-over application.

### Cover Options for Pre-Installation Blockout

#### Round Flush Cover

- SS316: Polished
- SS316: Brushed



Flush covers for pre-installation use special seals and support bushes to ensure static loads up to 4200 kg are properly supported. In order to achieve this drive-over rating, OptiClear™ or GripGlass™ must be used.

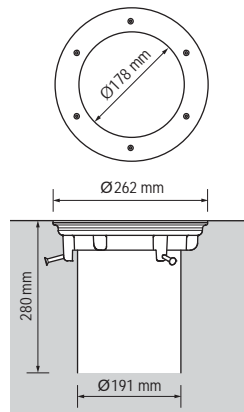

LS6052-K pre-installation blockout

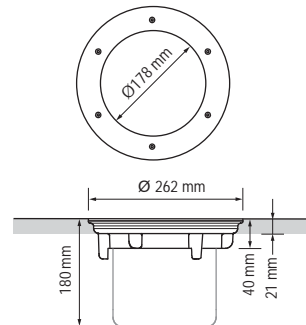

LS640 mounting collar

 CONFIGURE THIS PRODUCT >

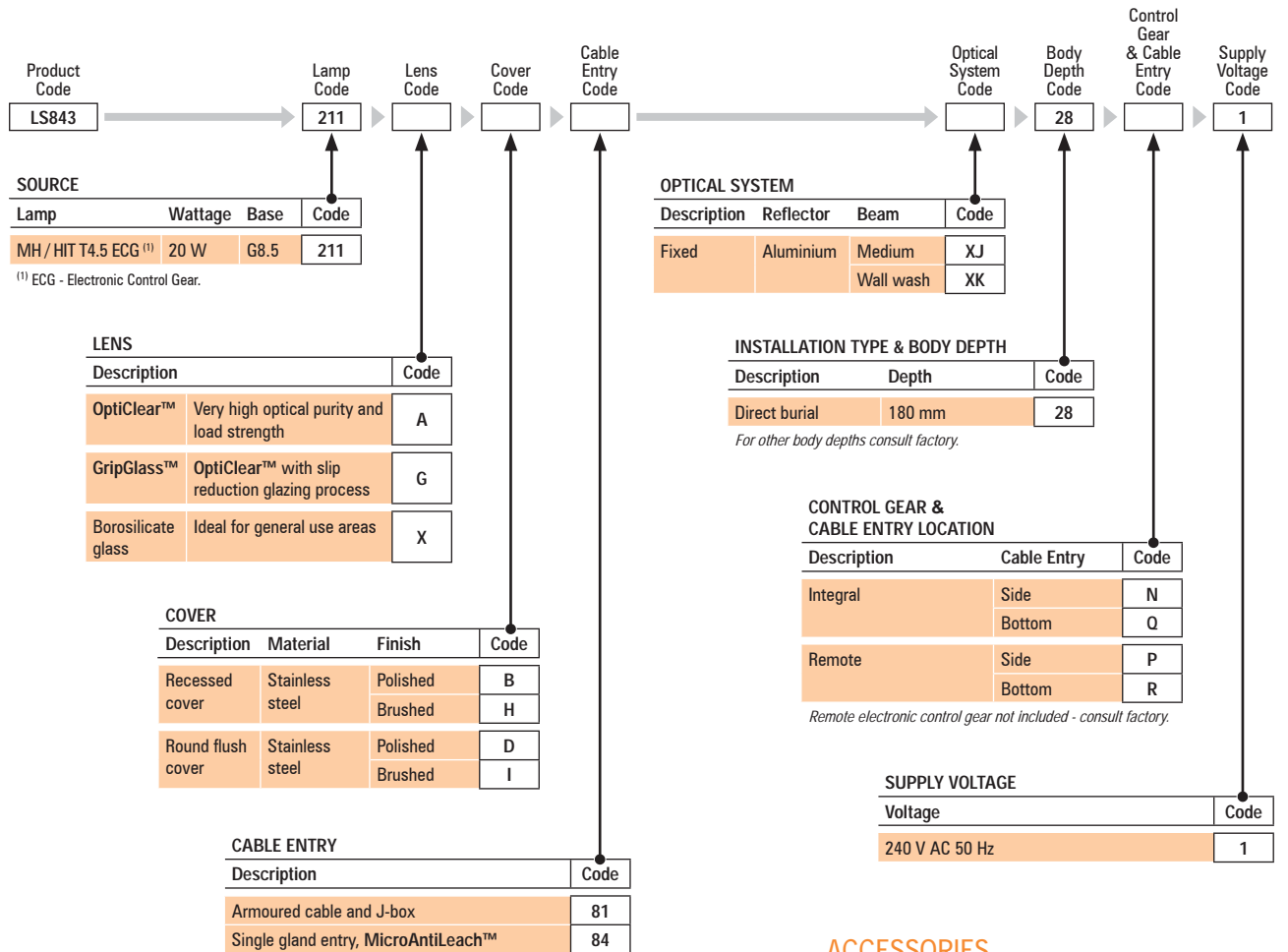

ACCESSORIES

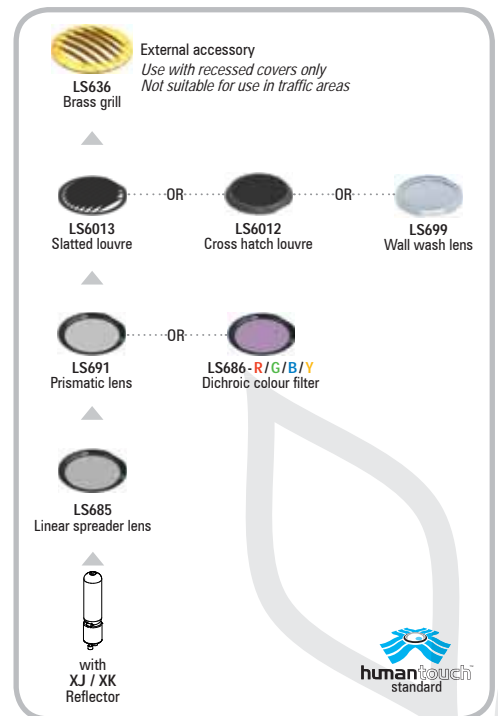

Other accessory stacking options may be available - consult factory

WHY USE DIRECT BURIAL

Direct burial installation is ideal for landscaping areas or in locations where the depth is restricted. This type of installation also allows for maximum heat dissipation. The stainless steel construction of the luminaire performs flawlessly in alkaline and acidic soil types, as well as chemically fertilised landscapes.

Cable Entry Option for Direct Burial

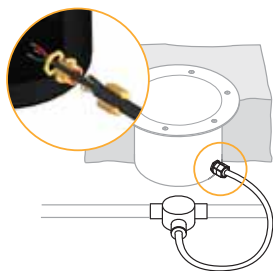

Armoured Cable & Junction Box

Armoured cable 0.6 m provides protection against damage to cable between luminaire and 3 way junction box (included). Allows for loop in/loop out and flexibility of luminaire placement.

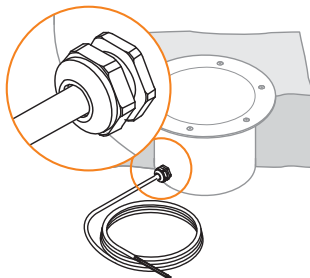

Single Gland Entry

MicroAntiLeach™ and 3 m flexible cable provide additional protection to luminaire against water ingress via cable.

Lens Options



OptiClear™ Glass

Glass of very high optical purity and load strength. Suitable for drive-over applications.

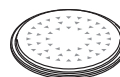

GripGlass™

OptiClear™ glass with slip reduction glazing process. Suitable for drive-over applications.



Borosilicate Glass

Ideal for general use areas. Not suitable for drive-over application.

Cover Options for Direct Burial



Recessed Cover

- SS316: Polished
- SS316: Brushed

Use recessed cover for installation in soil, grass, pavers and other uneven surfaces where no cover overhang is desired.

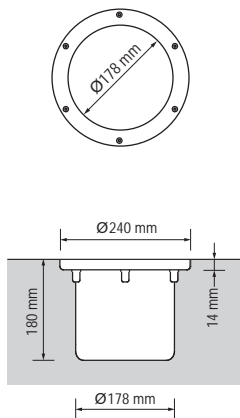

Round Flush Cover

- SS316: Polished
- SS316: Brushed

Use flush covers for installation in fine finished surfaces such as granite and marble. They can also be used in some suspended applications (decks, etc). The flush cover will conceal gaps between the luminaire and the surrounding surface.

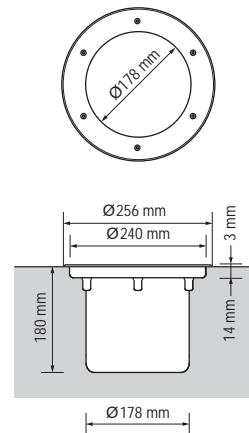

PHOTOMETRICS

IES data is available at [www.lumascap.com.au](http://www.lumascap.com.au) ▶ Technical Data ▶ Photometric Files.

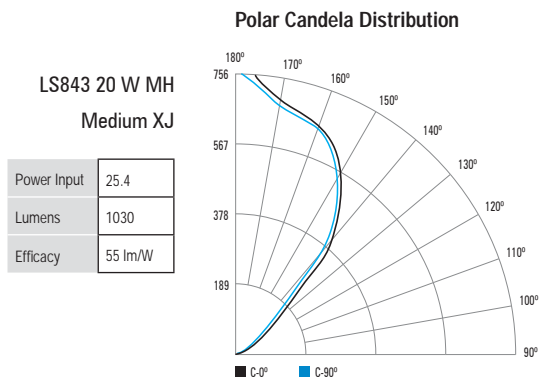

	C 0°	C 15°	C 30°	C 45°	C 60°	C 75°	C 90°
90°	0	0	0	0	0	0	0
100°	0	0	0	0	0	0	0
110°	5	6	6	7	7	8	9
120°	35	36	37	39	41	43	46
130°	103	106	109	112	116	121	127
140°	247	250	257	269	286	318	358
150°	481	469	480	499	514	527	538
160°	589	584	592	607	619	631	641
170°	650	653	657	664	673	682	687
180°	775	775	775	775	775	775	775

Illuminance at a Distance

m	Center Beam lx	Beam Ø
1	737	160 cm
2	184	319 cm
3	82	479 cm
4	46	638 cm
5	30	798 cm

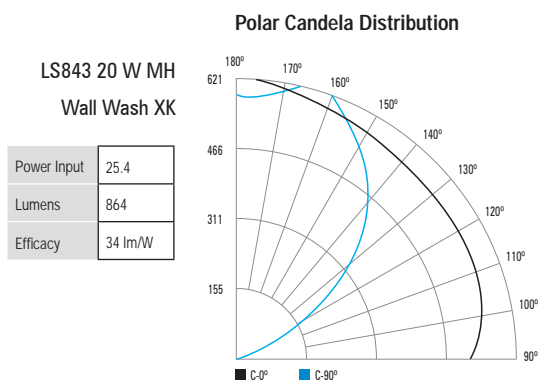

	C 0°	C 15°	C 30°	C 45°	C 60°	C 75°	C 90°
90°	0	0	0	0	0	0	0
100°	9	8	8	5	3	0	0
110°	63	62	56	45	30	13	10
120°	172	185	163	122	83	43	28
130°	329	325	308	290	189	106	55
140°	457	444	437	405	356	250	114
150°	544	531	516	510	491	425	285
160°	621	593	567	561	554	537	473
170°	596	594	588	587	577	574	553
180°	585	585	585	585	585	585	585

Illuminance at a Distance

m	Center Beam lx	Beam Ø
1	573	124 cm
2	143	248 cm
3	64	371 cm
4	36	495 cm
5	23	619 cm