



NO POWER TOOLS



DO NOT USE SILICONE ON OUTSIDE SURFACE



KEEP ELECTRONICS FREE FROM DIRT AND MOISTURE



DO NOT HOSE OR PREASSURE CLEAN

**MODEL** LS9120 | LS9140  
**INSTALLATION TYPE** Surface Mount  
**IP RATING** IP66  
**SUPPLY VOLTAGE** 110-240 V AC, 50/60 H  
**INSTRUCTIONS COVER** Single Colour (dimming)  
 Color Changing  
 Tunable White

## LS9120 / LS9140 Facade Luminaire



Warranty void if not installed as per installation instructions

DANGER

ISOLATE LUMINAIRE FROM POWER

Failure to isolate power supply before installation or maintenance may result in fire, serious injury, electric shock, death and may damage the luminaire.



WARNING

Connecting the luminaire incorrectly can lead to permanent damage and void warranty.

**Wiring Details**

CE Color Code	UL / ETL Color Code	Designation
Green / Yellow	Green	Earth / Ground
Brown	Black	Active / Live
Blue	White	Neutral
Black	Grey	Data*

\* Data wire must be appropriately insulated if not connected.  
 Operating voltage on this wire is 24 V. Incorrect wiring will damage luminaire and void warranty. Do not Hi-Pot test.

Bootlace ferrules must be used on all wires when connecting in terminal blocks.

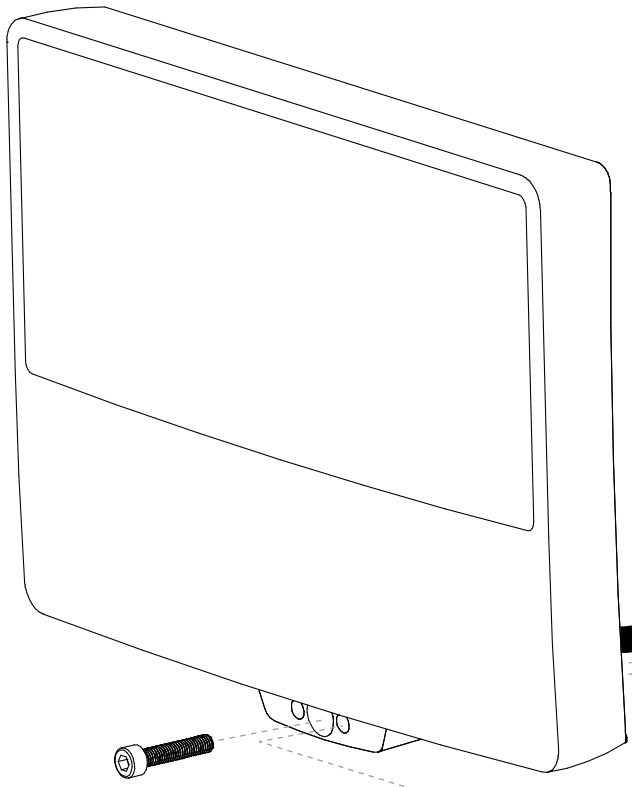

**Bracket Mounting Screw**  
 Use screw to attach luminaire to mounting bracket.

**Allen Key**  
 Use Allen key to lock luminaire tilt into position after adjusting tilt.

**Base View of Mounting Bracket**

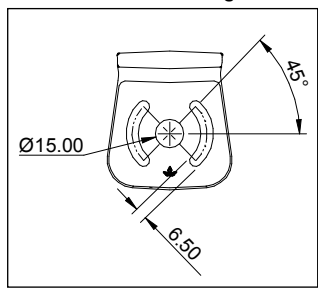

**Luminaire Cable**  
 Connect to a suitable power supply in accordance with local wiring rules.

**Washer Plate**  
 Use washer plate when attaching the mounting bracket to an accessory or when mounting to any mounting surface using a countersunk screw.

**Mounting Bracket**  
 Use to attach luminaire to suitable mounting surface. Note that mounting bracket can be flipped upside down if required for installation purposes. Do not use mounting bracket with countersunk screws unless using in conjunction with washer plate.

**Questions?**  
**Call +61 7 3854 5000**  
**Email [sales@lumascape.com.au](mailto:sales@lumascape.com.au)**  
**[www.lumascape.com.au](http://www.lumascape.com.au)**

---

## **SAFETY INSTRUCTIONS**

**WARNING - To reduce the risk of FIRE or INJURY:**

1. Luminaires and transformers to be installed by licensed electrical contractors.
2. Luminaires to be used for intended purpose only.
3. Do not operate the luminaires with a missing or damaged parts.
4. Use only genuine Lumascope parts to replace damaged or missing components.
5. Refer to instructions for installation and operating requirements.
6. Ensure installation complies with local regulations

**Voltage insulation test (megger) will permanently damage product and will void warranty.**

**SAVE THESE INSTRUCTIONS.**